



- 51-923 NON REGULATED**
- 51-924 SINGLE REGULATED**
- 51-925 DOUBLE REGULATED**

IMPORTANT NOTE: IF THIS PRESSURE TANK IS TO BE USED FOR SPRAYING FLAMMABLE MATERIALS, OPERATOR MUST NOT PRESSURIZE THIS TANK MORE THAN 15 PSI TO MEET OSHA REQUIREMENTS. FOR NON-ASME PRESSURE VESSELS. IT IS THE RESPONSIBILITY OF THE OPERATOR TO FOLLOW THIS MANDATORY PROCEDURE.

GENERAL INFORMATION

This pressure tank is equipped with either single or double air pressure regulation, pressure safety relief valve, tank vent valve, bottom outlet ball valve, four caster wheels and air powered agitator.

1. Turn regulators to zero. Close ball valves. Turn agitator knob to off position. Fill tank with product and tighten down lid with wrench provided.
2. With air from compressor on, open ball valves. Adjust pot pressure as needed to flow material to gun.
3. Adjust gun regulator if provided, to atomize material as needed.
4. Adjust agitator knob to the slowest speed that mixes the material as needed.

CAUTION!

1. Maximum tank pressure of 80 psi. The safety relief valve is designed to protect the tank against excessive pressures. DO NOT attempt to make adjustments to this valve. If this valve begins to vent air, reduce the setting on the air inlet regulator.
2. DO NOT alter the tank in any way by welding, drilling or machining as this may weaken the structure of the tank.
3. To prevent hazardous static sparks from occurring, always ground the tank by connecting a 12 ga. wire to the tank and to a known earth ground.
4. Be sure tank pressure is completely relieved before attempting to remove tank cover or material fill cap. Shut off the main air supply to the tank and vent pressure using the vent valve located on the tank lid.

****NOTE** Oiless Motor Used on CAT Agitated Tanks - DO NOT OIL TANK MOTORS**

ITEM NO.	PART NO.	DESCRIPTION	ITEM NO.	PART NO.	DESCRIPTION
1	51-578SS	Tank Shell	20	51-234	Tank Vent Valve
2	51-520	Gasket	21	51-268	90 Degree Elbow
3	51-575SS	Tank Lid Assembly	22	51-247	Speed Control Valve for Agitator
4	52-58	Pressure Gauge	23	51-267	4 Way Union
5	51-229	Safety Relief Valve Assembly	24	52-150	Air Shut Off Valves
6	51-535SS	Guard	25	52-6	Air Regulator (51-222 - 2nd Reg.)
7	98-0115	Nut 3/8-16	26	51-239	Double Male Nipple
8	51-245	Seal Ring	27	51-237	Air Flow Diffuser
9	51-287SS	Air Motor Base	28	51-233	Pin Assembly
10	51-289	Shaft Seal Assembly	29	51-236	Eye Bolt Assembly
11	51-288	Guide	30	51-224	Caster (4 Req'd)
12	51-242	Coupling		51-252	Optional Stationary Feet (4 Req'd)
13	51-262	Set Screw 1/4-20 x 1" lg.	31	51-275SS	Fluid Outlet Elbow
14	51-271	Muffler	32	51-274SS	Fluid Outlet Ball Valve
15	51-240SS	Air Motor	33	51-574SS	Agitator Shaft
16	51-266	Roll Pin	34	51-259SS	Retaining Nut
17	51-264	Screw & Nut 1/4-20 x 1/4 lg.	35	51-246	Propeller W/ Bolt
18	51-524	Material Fill Cap	36	51-225	Wrench
19	51-522	Seal Ring - Filler Cap			

Optional

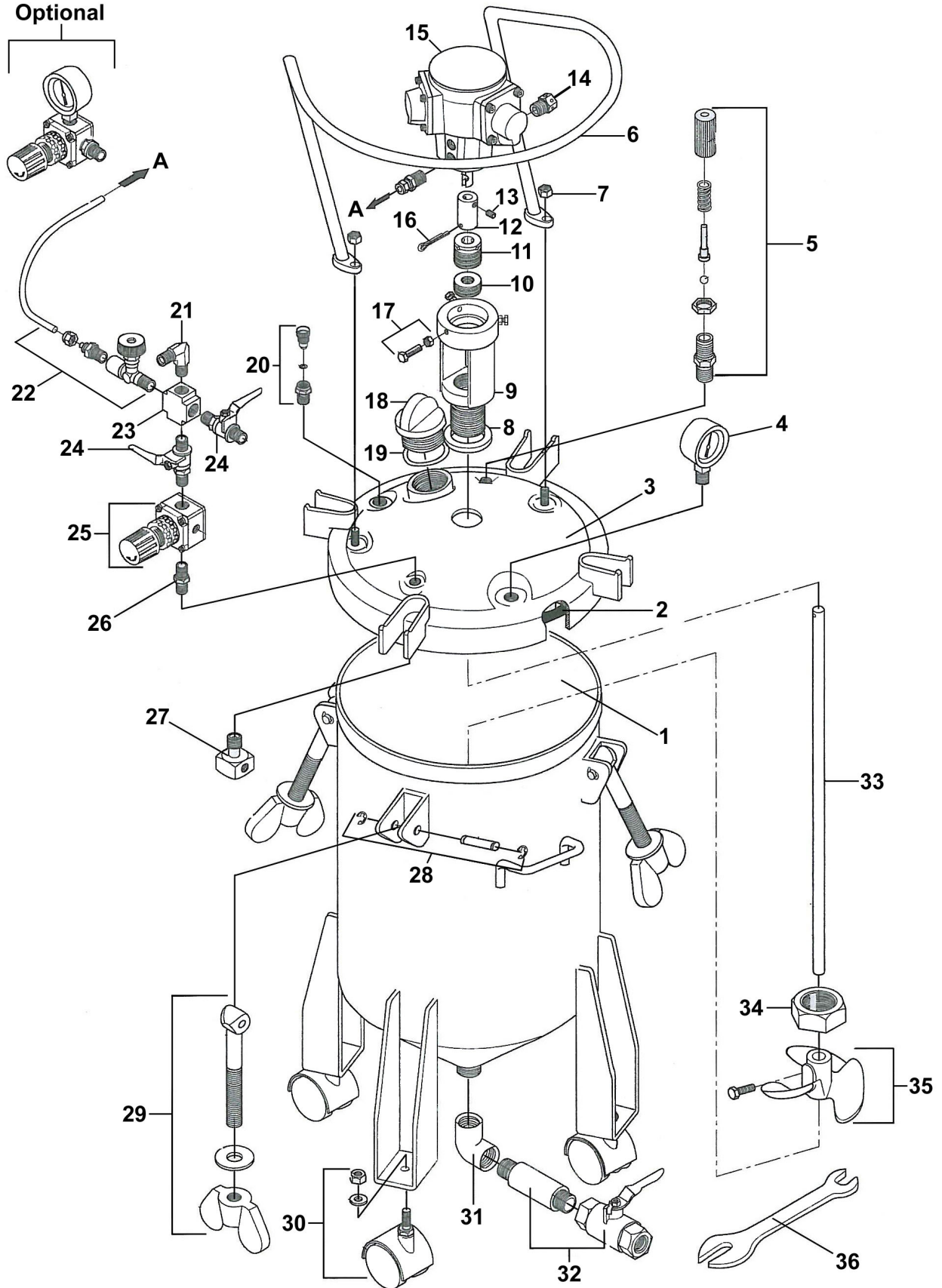

BOTTOM OUTLET SS PRESSURE TANKS

Bottom Outlet Pressure Tanks Available From C.A. Technologies



2.5 Gallon	PART NO.	REGULATORS	AGITATOR
	51-910	0	None
	51-911	1	None
	51-912	2	None
	51-913	1	Air
	51-914	2	Air
	51-915	0	Air

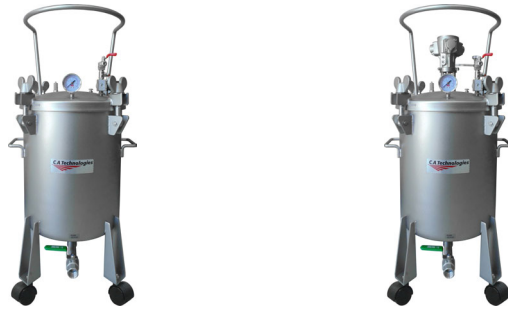

5 Gallon	PART NO.	REGULATORS	AGITATOR
	51-920	0	None
	51-921	1	None
	51-922	2	None
	51-923	1	Air
	51-924	2	Air
	51-925	0	Air



12.5 Gallon	PART NO.	REGULATORS	AGITATOR
	51-940	0	None
	51-941	1	None
	51-942	2	None
	51-943	1	Air
	51-944	2	Air
	51-945	0	Air